2023-2024 4-H Quilt Block and Top Challenge Pattern
“Flying Flags” by Amy Smart, Diary of a Quilter



Instructions to assemble blocks and top on next pages.

Flying Flags - 66" x 80" Finished Quilt

Quantity: 20 blocks

Fabric Requirements

- Navy: 20 squares cut 6 ½ inches by 6 ½ inches each (¾ yard of fabric to make 20 squares).

Hint: for red, white, and light blue fabric, use Jelly Roll pre-cut fabrics as they are pre-cut 2 ½ by 42 inches. Most Jelly Rolls have 20 strips per roll.

- Red: 20 strips (2 ½ inches wide by 42 inches long) (1 Jelly Roll).
 - White: 20 strips (2 ½ inches wide by 42 inches long) (1 Jelly Roll).
 - Light blue: 40 strips (2 ½ inches wide by 14 ½ inches long) (2 Jelly Rolls).
- Hint: Save leftover light blue fabric for first border, if making a quilt top.*



Example Jelly Roll

Block Assembly

Fabric requirements per quilt block to be cut from fabric above:

1 navy square 6 ½ x 6 ½
2 red strips 2 ½ x 8 ½
1 red strip 2 ½ x 14 ½

1 white strip 2 ½ x 8 ½
1 white strip 2 ½ x 14 ½
2 light blue strips 2 ½ x 14 ½

All seams are sewn with a ¼ inch seam. All fabric pieces are sewn right sides together.

Block Sewing Steps

Step 1

- Sew the three 8 ½ strips together: red strip, white strip, red strip.
- Press seams toward red strips.

Step 2

- Sew the one white and one red strip 14 ½ together.
- Press seam toward red strip.

Step 3

- Sew the 6 ½ x 6 ½ navy square to the three 8 ½ red-white-red strip set.
- Press seam toward the blue square.

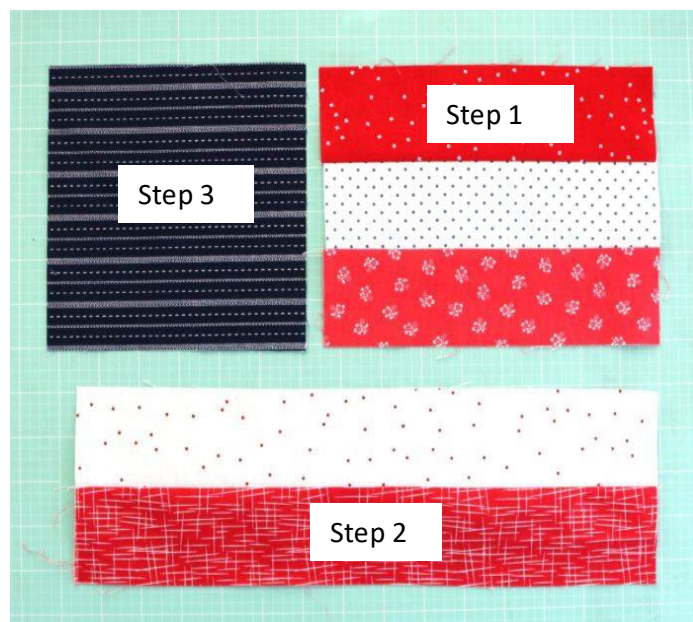

Step 4

- Sew bottom red-white strip set to the top blue square-red-white-red unit.
- Press seam toward long white strip.

Step 5

- Sew one light blue $2\frac{1}{2} \times 14\frac{1}{2}$ to the top of the flag block.
- Sew one light blue $2\frac{1}{2} \times 14\frac{1}{2}$ to the bottom of the flag block.
- Press seams toward the light blue strips.

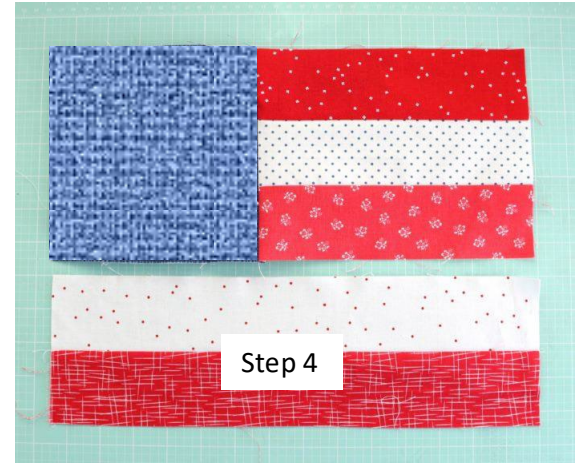

This will complete one $14\frac{1}{2} \times 14\frac{1}{2}$ quilt block.
Make 19 more blocks!

To make one quilt top

Use the 20 blocks assembled above and the following fabric for the borders, binding and backing.

Fabric Requirements

- Inside Border
 - Light blue: left over fabric from block construction above (2 ½ inches wide by 42 inches long).
- Outside Border
 - Navy or Red: 7 strips (3 ½ inches wide by 42 inches long)
- Binding
 - Navy or Red: 7 strips (2 ½ inches wide by 42 inches wide)
- Backing
 - Coordinating Navy, Red, or Light blue: 4 yards
- Batting
 - Use quality batting sold in craft or big box stores. Comes in a bag by quilt size. Use twin size batting.

Quilt Top Sewing Steps

Lay out flag blocks with 4 blocks across and 5 blocks down.

Step 1

- Sew blocks together into rows of 4 flag blocks to equal 5 rows.
- Press seams towards the light blue fabric.

Step 2

- Sew rows together into one top.
- Press seams toward light blue fabric.

Step 1



Step 2

